



LEARNING & LIBRARY HUB NEWS

A new Learning and Library Hub is coming to Warrnambool!

South West TAFE and the Warrnambool City Council have joined together to deliver a state-of-the-art learning and library hub for the people of Warrnambool.

The Project

The Victorian Government is partnering with Warrnambool City Council and South West TAFE to deliver the \$20.25 million Warrnambool Learning and Library Hub.

The new building will replace the existing library in Liebig Street, with library members and visitors able to enjoy all the current library services in new, larger, modern and accessible spaces. It will provide more spaces for meetings, social activities and programs.

The new learning hub and library will be a social space for interaction and knowledge exchange with free access to computers, study areas, learning and play opportunities for children.

The hub will be located on the South West TAFE campus (see image).

Community consultation

Over the coming months there will be a range of opportunities for the Warrnambool and surrounding communities to share their vision, ideas and opinions during the lifespan of the project, and the public will be notified when the consultation phase begins.

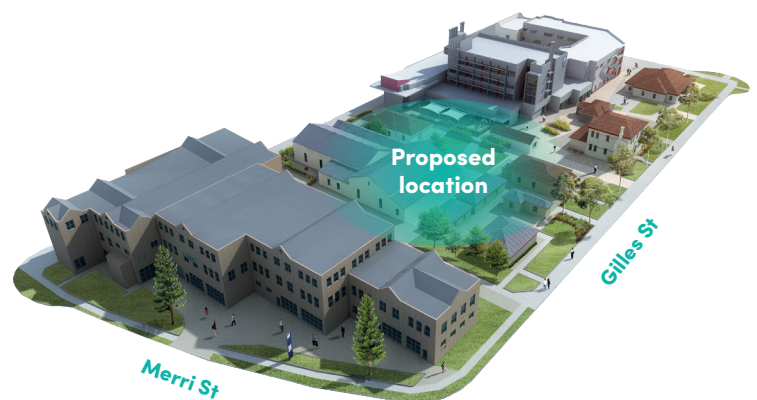

Questions?

What is a 'learning and library hub'?

This exciting new community space in the CBD will be a place that brings together library facilities and other new services to meet the needs of both the community and South West TAFE students and staff, in new and refurbished buildings at the TAFE's Warrnambool Campus.

The hub will house our new community library, along with the latest technology, resource materials and shared spaces to expand and improve educational facilities and provide better access for residents, visitors and South West TAFE students and staff.

Where will the new hub be located?

The hub will be located on South West TAFE's Warrnambool campus.

When will the hub be open?

It is expected that the hub will open mid-2022.

More information

For further information, visit the websites of South West TAFE (swtafe.edu.au/library) and Warrnambool City Council (warrnambool.vic.gov.au/warrnambool-learning-and-library-hub).



The new learning and library hub will be a wonderful meeting place for our growing community, from students and teachers to younger readers and the many thousands of current library members.

Project timeline

- ✓ Funding announced
OCTOBER 2018
- ✓ Project Control Group appointed
MARCH 2019
- ✓ Architect appointed
DECEMBER 2019
- ✓ Start design & community consultation
FEBRUARY 2020
- Tender for construction
MAY 2020
- Builder appointed
DECEMBER 2020
- Project construction
JAN 2021-MARCH 2022
- Learning and Library Hub opens
MID-2022

Questions?

If there is anything you would like clarified, please get in touch: WCC 5559 4800 or SWTAFE 1300 648 911